



EBYSHINE

DESIGNED FOR EXPLORATION,
BUILT FOR PERFECTION

EBYSHINE

at a glance...

Welcome aboard the luxury yacht EBYSHINE, a masterpiece of modern marine engineering and elegance. Crafted in 2023, this motoryacht offers unparalleled comfort and style.





SPECIFICATIONS

BUILD
2023

LENGTH
30m (98'5")

BEAM
6.94m (22'7")

DRAFT
2.25m (7'5")

CABINS
5

ENGINES
2 x Man 641HP





























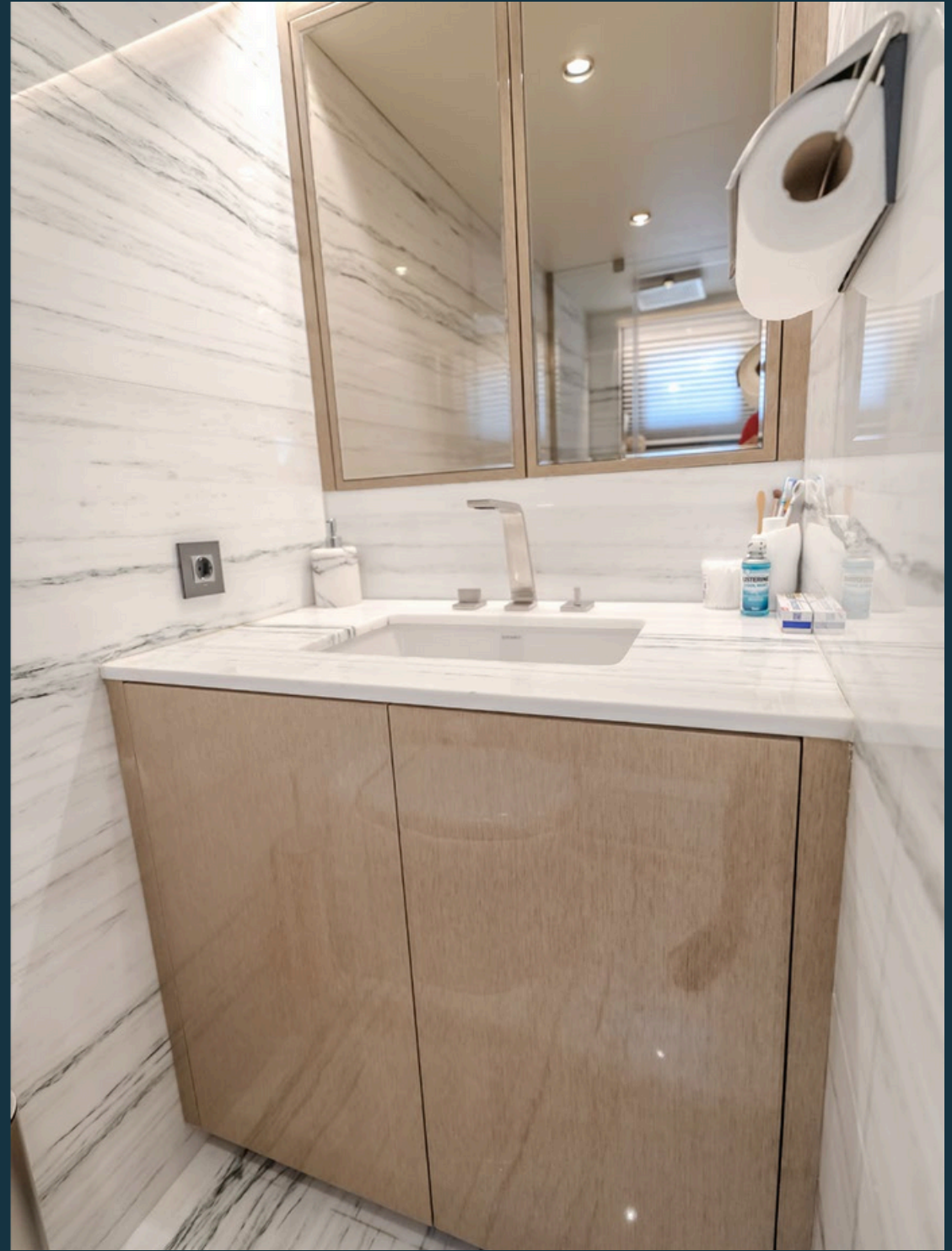







SPECIFICATIONS: EBYSHINE

Dimensions

Length	30m (98'5")
Beam	6.94m (22'7")
Draft	2.25m (7'5")
Gross Tonnage	219 GT

Construction & Design

Built	2023
Builder	Blaundus Yachts
Hull Material	Steel
Model	Blaundus B30
Exterior Designer	Unique Yacht Design
Interior Designer	Blaundus Yachts

Accommodation

Guests	10 guests in 5 staterooms
Staterooms	5 (3 master double, 2 twin guest)
Crew	5 crew in 3 cabins

Performance & Engines

Cruising Speed	10 Knots
Max Speed	13.5 Knots
Cruise Range	3.375 nm
Range	4.500 nm
Engines	2 x Man 641HP (D2676LE425)
Generators	2x Kohler, 55 kw, 45 kw)

Class & Flag

Classification	Registro Italiano Navale (RINA-C)
Flag	UK

Features & Types

Stabilizers	Underway
-------------	----------

SPECIFICATIONS: EBYSHINE

ACCOMMODATIONS

OVERVIEW

10 Guests in 5 Staterooms and 5 Crew in 3 Cabins

LOWER DECK

6 Guests in 1 Master Cabin and 2 Twin Guest Cabins

MAIN DECK

Master Cabin for 2 Guests

OWNER'S STATEROOM

Fly Deck Master for 2 Guests

CREW ACCOMODATION

5 Crew in 3 Cabins (1 Single Captain Cabin and 2 Bunk Bed Cabins, all en-suite), Crew Galley and Crew Mess

CONSTRUCTION

- Hull Material: Steel
- Superstructure Material: Aluminium and Composite
- Decks Material: Teak

CAPACITIES

- Gross Tonnage: 219
- Fuel Capacity: 27,059 L
- Fresh Water Capacity: 6,490 L
- Grey Water: : 2.312 L
- Black Water: : 2.312 L
- Sludge Tank (For Hammann) : 1.004 L
- Fuel Overflow Tank : 364 L
- Bilge Water Tank: 364 L

PERFORMANCE

- Maximum Speed: 13.5 kts – 140 lt per engine/hour – Range: 1,300 nm
- Cruising Speed: 10 kts – 40 lt per engine/hour – Range: 3,375 nm
- Economical Speed: 9 kts – 30 lt per engine/hour – Range: 4,050 nm

SPECIFICATIONS: EBYSHINE

MAIN MACHINERY

- Main Engines: 2 x MAN 650 HP, D2676 Medium Duty
- Engine Hours (October, 2025):Port: 408 hrs Starboard: 412 hrs
- Propulsion Type: Direct shafts
- Engine Controls: Joystick & Rudder – Data, Starter Arms – Man
- Gear Boxes: ZF
- Propellers: CJR
- Engine Ventilation: Yes

GENERATORS & ELECTRICITY

- Output/Electricity: 24/380
- Generators: 2 x Kohler, 45 kW,
- Generator Hours (October 2025):45 kW: 1850 hrs – 45EF0ZDJ 45 kW: 1850 hrs – 45EF0ZDJ
- Generator Fuel Consumption: 7 lt/h
- Generator Exhaust System: Centek Marine Model : 1020400
- Shore Power: 220v
- Shore Power Converter: Yes
- Shore Power Transformer: Yes
- Batteries: 12x Arti Marin A602-1250 2.27v
- Generator Start: 2 x Mastervolt 130A 24v
- Engine Start: 2 x Mastervolt 225A 24v
- Generator Charger: 2x Chargers Master Plus (24-12-3) , 24V
- Engine Chargers: 2x Chargers Master Plus (24-20-3) , 24V
- Service Battery Chargers: 2x MassCombi Pro(24/3500) – 100

AUXILIARY MACHINERY

- Steering System: Data
- Bow Thruster: Hydraulic / DATA Model : Dhs 200-2x147-2tb-4b 380w 3 kw
- Stern Thruster: Hydraulic / DATA Model : 200-2x147-2tb-4b 380w 3kw
- Stabilizers: Yes, CMC Marine, Fin Model : 3153
- Under Water Lights: 35x

Fuel & Oil System

- Fuel Oil Separator: Alfa Leval Model : Mib 3 s 13/33 7500 RPM
- Fuel Transfer Pump: Feit Model : GR50TM/VT+Bypass 1430 RPM
- Fuel Filling Pump: Yes
- Dirty Oil Pump: Yes
- Engine room ventilation: 230 kW

Firefighting & Bilge System

- Firefighting & Bilge System: FeitModel : TSL 25/1 1455 RPM
- Firefighting & Bilge Pump: Feit Model : TSL 25/1 1455 RPM

Fresh Water System

- Fresh Water Makers: x 2 Delfin Model : Maxi 7000 (300L/h)
- Fresh Water Pressure: Yes
- Hot & Cold Circulation Pump: Yes
- Hot Water Boilers: x 2 Feit Model TR 150)150L 39.6 gal
- Sea Water Pumps: Yes

SPECIFICATIONS: EBYSHINE

Black & Grey Water System

- Black & Grey Water Treatment: Tecnicomar / Model Ecomar 32S 400V
- WC's (toilets/bidets): TECMA / ELECTRIC
- Black Water Pumps : Tecnicomar – Electric
- Grey Water Pumps: Tecnicomar – Electric

AC & Ventilation System

- Air Conditioning: Dometic air conditioning system
- Air Compressor: Yes
- Air Handling Units: Yes
- Power: 252000 BTU – 14 total
- Engine Room AC: Yes
- Engine Room Ventilation: Yes
- Galley Ventilation & Extraction: Yes
- Refrigerator: Dometic CRX 00050
- Hydraulic System: Data Hydraulic System
- Total Fan Coil Capacity (BTU): 252,000
- Total Fresh Air Capacity (BTU): 27,000
- Total Chiller Capacity (BTU): 216,000

NAVIGATION SYSTEMS

- Navigation Equipment 1 : Fruno Navnet Tzt BB – 19T22
- Navigation Equipment 2 : Fruno Navnet Tzt BB – 19T22
- Navigation Equipment 3 : Fruno Cctv – 19T22
- X-Band Radar: Furuno DRS12a-X CLASS RADAR
- UPS (Emergency Source): Victron
- Magnetic Compass: Custom Made MB 1100
- Auto Pilot: Simrad – A2004
- Rudder Angle Indicator System: Data Marine
- EPIRB: Sailor 4065
- GPS: Furuno GP-330B
- AIS: I - AIS Class B GPA-017S FA -50
- Navtex: Furuno NX300
- Horn: Custom Made
- Search & Rescue Transponder: Sailor SART II
- Search & Rescue Transponder: Epirp B
- Night Vision Camera: Flir MC 300
- VHF 1 : Furuno FM 0560
- VHF 2 : Furuno FM 4800
- Portable VHF: Sailor SP3520

SPECIFICATIONS: EBYSHINE

DECK MACHINERY & EQUIPMENT

- Anchors: x 2 (1 Custom Made - 1 Ultra)
- Anchor Chains: 250 M - 250 M - 16mm
- Anchor Windlass System: Data
- Passerelle: Custom Made / SOMER
- Sea-stair: Custom Made SOMER (Hydraulic System)
- Swimming Ladder: Chrome Ladder Manual Installation
- Paint Underwater: JOTUN

SAFETY, SECURITY, & FIRE FIGHTING EQUIPMENT

- Security System: MFIRE
- Monitors: 2x 1 Crew mess / 1 Bridge
- Fixed Firefighting System: Yes
- Firefighting Equipment: Yes
- Smoke Detection: Yes
- Fire Alarm: Yes
- Alarms: Yes
- Life Rafts: x 2
- Lifejackets: Yes
- Immersion Suits: Yes
- SART: Sailor
- Flares and Signals: Yes
- Medical Equipment: Yes

ENTERTAINMENT, AUDIO/VISUAL AND IT SYSTEMS

- Video Equipment: TV in all cabins
- TVRO: Yes + Apple TV
- Audio Equipment: LG TV and Surround Sound system in the living room
- Outdoors: JL Audio Sound System
- Control: Tablet Control
- Light Management: Tablet Control

TV

- Main Salon: LG - 76"
- VIP Master Stateroom: LG - 50"
- Master Stateroom: LG - 43"
- Master Guest Staterooms: LG - 43"
- Twin Stateroom : 2x Beko 43"
- Crew Salon : Dahua - 24"
- Crew Stateroom (Captain): Axen - 24"

SPECIFICATIONS: EBYSHINE

GALLEY & LAUNDRY EQUIPMENT

MAIN GALLEY EQUIPMENT

- Washing machine: Bosch 9 kg
- Refrigeration/Freezer: Gaggenau RF287370 / 01 – 212 Lt
- Dryer: Bosch 9 kg
- Bakery: Gaggenau BO480112 – 110 Lt
- Refrigerator: Gaggenau RC289370 / 01 – 289 Lt
- Microwave : Gaggenau BM450110 – 36 Lt
- Extra Refrigeration/Freezer: Beko – 85 LT
- Kitchen extractor : Elica

OTHER EQUIPMENT

- Sun Awnings: Yes
- Beach Club: Yes
- IACS Society: RINA
- Additional Class Information: Commercial & Private - Dual
- MMSI Number: 232050623
- Official Registration: 193382
- Home Port: London
- Call Sign: MOHV6

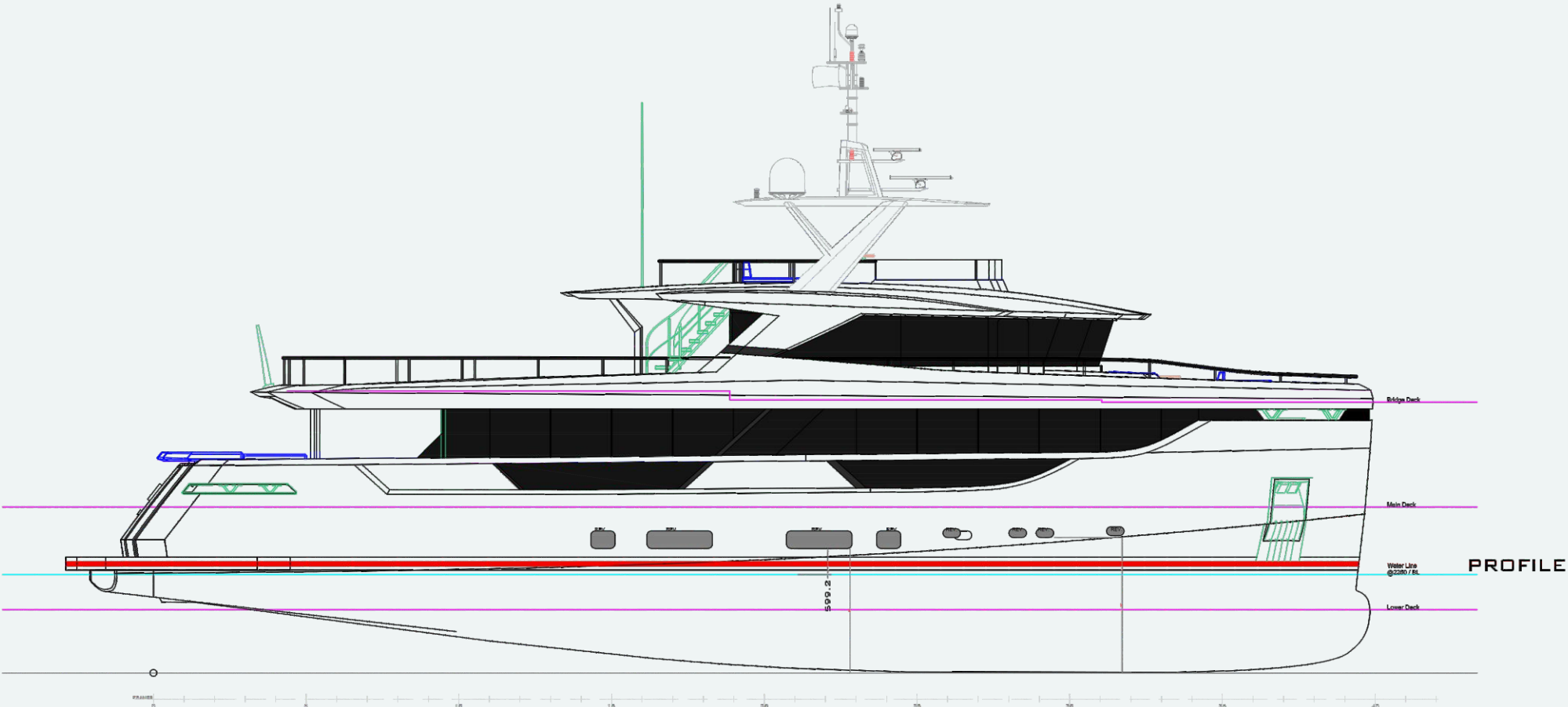

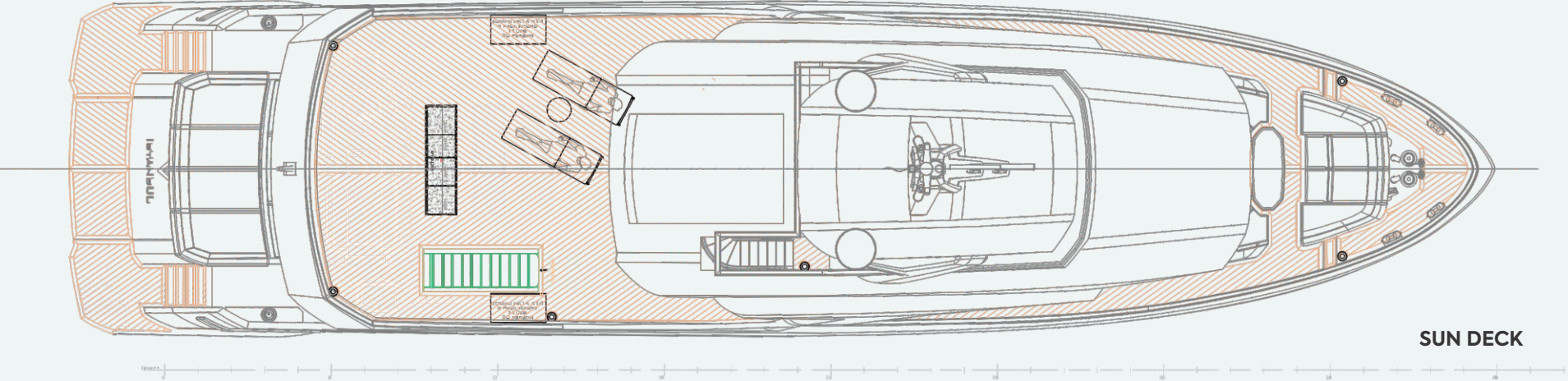

SUN DECK

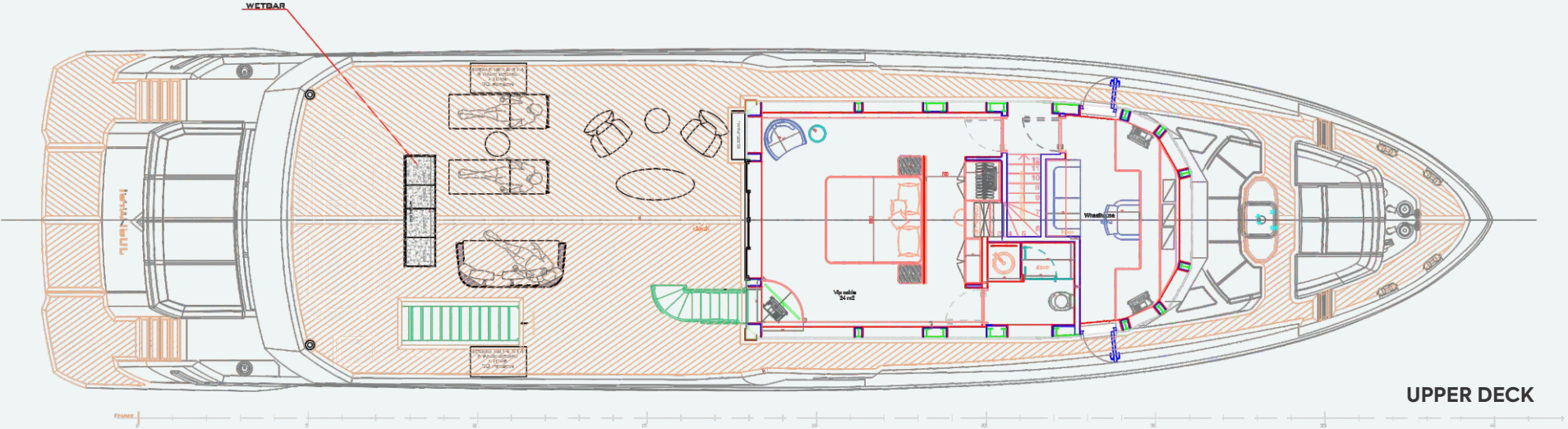

UPPER DECK

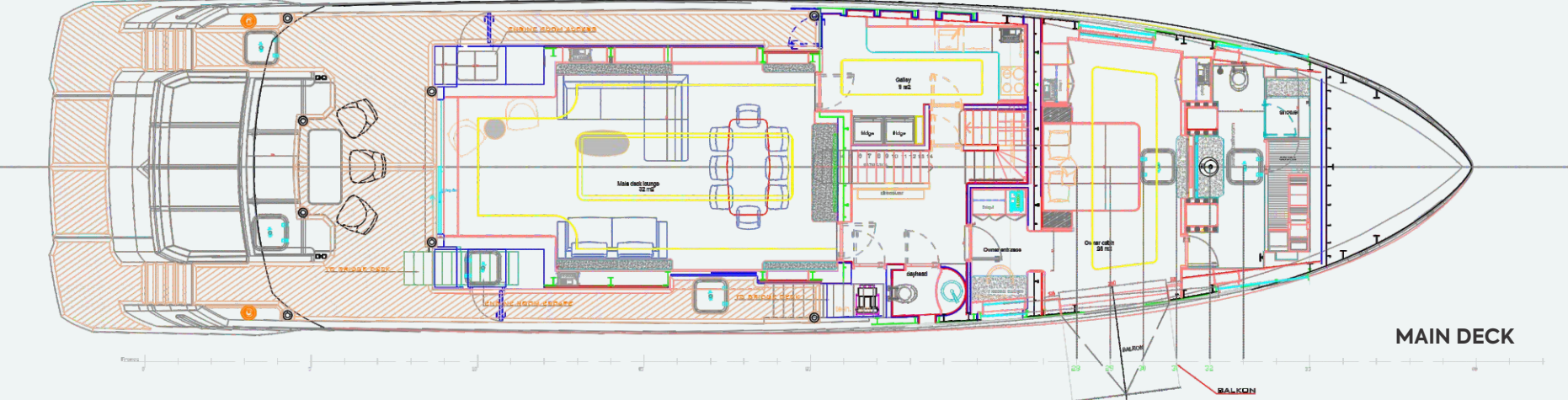

MAIN DECK

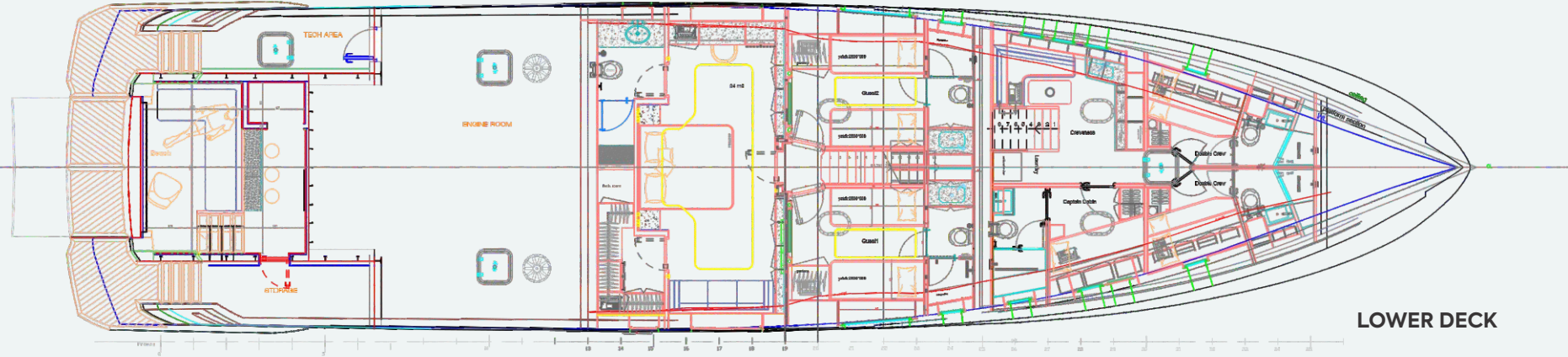

LOWER DECK



EBYSHINE